



WHATABURGER

BRAND NEW 20-YEAR LEASE AND 2024 CONSTRUCTION

PRYOR, OKLAHOMA



SUBJECT PROPERTY

Representative Photo





WHATABURGER

BRAND NEW 20-YEAR LEASE AND 2024 CONSTRUCTION

PRYOR, OKLAHOMA

Offering Memorandum Disclaimer

This Confidential Offering Memorandum ("Memorandum") is being delivered subject to the terms of the Confidentiality Agreement (the "Confidentiality Agreement") signed by you and constitutes part of the Confidential Information (as defined in the Confidentiality Agreement). It is being given to you for the sole purpose of evaluating the possible investment in the subject property mentioned herein ("the Project"), and is not to be used for any other purpose or made available to any other party without the prior written consent of the Seller of Record ("Managing Member"), or its exclusive broker, Marcus & Millichap ("Exclusive Broker"). This Memorandum was prepared by Exclusive Broker based primarily on information supplied by Managing Member. It contains select information about the Project and the real estate market but does not contain all the information necessary to evaluate the Project. The financial projections contained herein (or in any other Confidential Information) are for general reference only. They are based on assumptions relating to the overall economy and local competition, among other factors. Accordingly, actual results may vary materially from such projections. Various documents have been summarized herein to facilitate your review; these summaries are not intended to be a comprehensive statement of the terms or a legal analysis of such documents. While the information contained in this Memorandum and any other Confidential Information is believed to be reliable, neither Exclusive Broker nor Managing Member guarantees its accuracy or completeness. Because of the foregoing and since the investment in the Project is being offered on an "As Is, Where Is" basis, a prospective investor or other party authorized by the prospective investor to use such material solely to facilitate the prospective purchaser's investigation, must make its independent investigations, projections and conclusions regarding the investment in the Project without reliance on this Memorandum or any other Confidential Information. Although additional Confidential Information, which may include engineering, environmental or other reports, may be provided to qualified parties as the marketing period proceeds, prospective purchasers should seek advice from their own attorneys, accountants, engineers and environmental experts. Neither Exclusive Broker nor Managing Member guarantees the accuracy or completeness of the information contained in this Memorandum or any other Confidential Information provided by Exclusive Broker and Managing Member. Managing Member expressly reserves the right, at its sole discretion, to reject any offer to invest in the Project or to terminate any negotiations with any party at any time with or without written notice. Managing Member shall have no legal commitment or obligations to any prospective investor unless and until a written sale agreement has been fully executed, delivered and approved by Managing Member and any conditions to Managing Member's obligations thereunder have been satisfied or waived. Managing Member has retained Exclusive Broker as its exclusive broker and will be responsible for any commission due to Exclusive Broker in connection with a transaction relating to the Project pursuant to a separate agreement. Exclusive Broker is not authorized to make any representation or agreement on behalf of Managing Member. Each prospective investor will be responsible for any claims for commissions by any other broker in connection with an investment in the Project if such claims arise from acts of such prospective investor or its broker. This Memorandum is the property of Managing Member and all parties approved by Managing Member and may be used only by parties approved by Managing Member. No portion of this Memorandum may be copied or otherwise reproduced or disclosed to anyone except as permitted under the Confidentiality Agreement.

EXCLUSIVELY LISTED BY:

CRAIG ELSTER

Vice Presidents Investments

(949) 419-3223

craig.elster@marcusmillichap.com

Lic. CA 01958307

RON DUONG

Senior Managing Director Investments

Senior Director, National Retail Group

(949) 419-3233 direct

ron.duong@marcusmillichap.com

License: CA 01438643

BROKER OF RECORD:

Steve Greer

7633 East 63rd Pl., Ste. 300

Tulsa, OK 74133

Lic #: 206118

P: (225) 376-6800

steve.greer@marcusmillichap.com

Investment Highlights



Brand-New Construction Completed in 2024 with a 20-Year Lease Agreement



The Latest Prototype Double Drive-Thru Location is Designed to Handle Increased Order Volume

Prime Retail Location

- ▶ Located on Hwy 69 with **Traffic Counts Exceeding 23,000 Cars Per Day**
- ▶ The Subject Property boasts an **Expansive 2.12-Acre Lot, Providing Ample Space for 49 Parking Spots**
- ▶ Outparcel to the **Only Walmart Supercenter within 20 Miles - Walmart Recently Expanded and Renovated into a Supercenter, Proving Their Commitment to the Location**
- ▶ Within Close Proximity to Several Major Retailers such as Murphy USA, Domino's Pizza, RCB Bank, Chili's Grill & Bar, Verizon, Braum's Ice Cream, Kum & Go, Tractor Supply, Taco Bell, and Many More

Experienced Franchisee

- ▶ **Absolute NNN Property with Zero Landlord Responsibilities** - Ideal for Investors Not Local to the Market
- ▶ Whataburger has the Highest Average Sales Per Store of all Burger Quick Service Restaurants **at \$3.54 Million per Store**
- ▶ Whataburger's Sales **Skyrocketed in 2021, Reaching \$3.09 Billion** - A 14.5% Increase From 2020
- ▶ Whataburger has 873+ Locations Nationwide | Operated by K-Mac Enterprises, a Strong Operator with Over 320 QSR Locations
- ▶ Scheduled 10% Rental Increases Every 5 Years Throughout the Initial Term Provide for an Excellent Hedge Against Inflation

Pride of Property Ownership Pryor, OK

- ▶ **Located within 2 Miles of MidAmerica Industrial Park**, Oklahoma's Largest Industrial Park Spanning 9,000 Acres
- ▶ In 2022 **Google Invested Another \$75 Million** into their Facilities at MidAmerica Industrial Park Bringing their **Total Investment up to \$4.4 Billion**
- ▶ **Average Household Income** within 1 Mile **Exceeds \$75,000**



Representative Photo



SUBJECT PROPERTY

Representative Photo

Tenant Overview

Whataburger

Whataburger is an American fast food chain that specializes in hamburgers. It was founded in 1950 in Corpus Christi, Texas, by Harmon Dobson and Paul Burton. Today, it is headquartered in San Antonio, Texas, and has over 800 locations across the southern United States.



Whataburger is known for its large and customizable burgers, which are made with 100% pure beef and served on a five-inch toasted bun.

Whataburger is also known for its distinct logo, which features an orange and white striped "W." The chain has a loyal following, and many customers praise its quality ingredients and customer service.

Tenant Profile

Website	www.whataburger.com
Number of Locations	837+ (As of 2021)
Revenue	\$2.7 Billion (2021)

K-MAC Enterprises, Inc.

K-MAC Enterprises Inc. is a leading operator of Taco Bell quick-service restaurants. The company's restaurants, franchised from YUM! Brands, are located in Arkansas, Illinois, Indiana, Kentucky, Mississippi, Missouri, Oklahoma, Tennessee, and Texas. K-MAC was founded in 1964 by Ken McGruder.



Their guarantor is WAB Venture, Inc. with plans to develop 40 locations and a total of 12 locations in operation by the end of the year. They currently have nine locations open.

Operating Tenant Profile

Headquarters	Fayetteville, AR
Number of Locations	9 Locations
Annual Sales	\$530 Million

Average Unit Volume - Rankings

Fast Food Restaurant Chain	Average Unit Volume	Increase YoY
Whataburger	\$3,538,900	11%
McDonald's	\$3,349,800	16%
In-N-Out	\$2,781,100	4%
Habit Burger	\$1,613,600	11%
Wendy's	\$1,880,700	8%
Jack in the Box	\$1,797,400	12%
Del Taco	\$1,498,300	7%
Burger King	\$1,412,200	3%
Carl's Jr	\$1,270,000	3%
Sonic Drive-In	\$1,648,900	2%
Arby's	\$1,309,000	5%



Financial Analysis

Offering Summary

Property Name	Whataburger
Property Address	5315 South Mill Street Pryor, OK 74361
Year Built	2024
Gross Leasable Area (GLA)	±3,371 Square Feet
Lot Size	±2.12 Acres (±92,347 Square Feet)

Pricing

Price	\$4,210,000
Cap Rate	6.65%

Annualized Operating Data **Current**

Gross Potential Rent	\$280,000
Total Expenses	Absolute NNN
Net Operating Income	\$280,000

Lease Information

Initial Lease Term	±20 Years
Lease Commencement Date	April 5, 2024
Lease Expiration Date	April 4, 2044
Lease Remaining	±20 Years
Lease Type	Absolute NNN
Increases	10% Every Five Years
Options	Five, Five-Year
Guarantee	Franchisee

Representative Photo



Market Overview

Close-Up Aerial & Site Plan



 JOHN DEERE

 State Highway 69
±23,000 Cars Per Day

RCB BANK
That's my bank!





MURPHY USA

Walmart
Save money. Live better.

Hotel Pryor

DODGE



Google Google Data Center has ±800 employees

MidAmerica Industrial Park
Oklahoma's largest industrial park,
3rd largest in the country & includes
the following companies:



69 State Highway 69
±23,000 Cars Per Day

DODGE

Hotel Pryor



SUBJECT PROPERTY
Representative Photo

Domino's T-Mobile

Market Overview

Regional Map

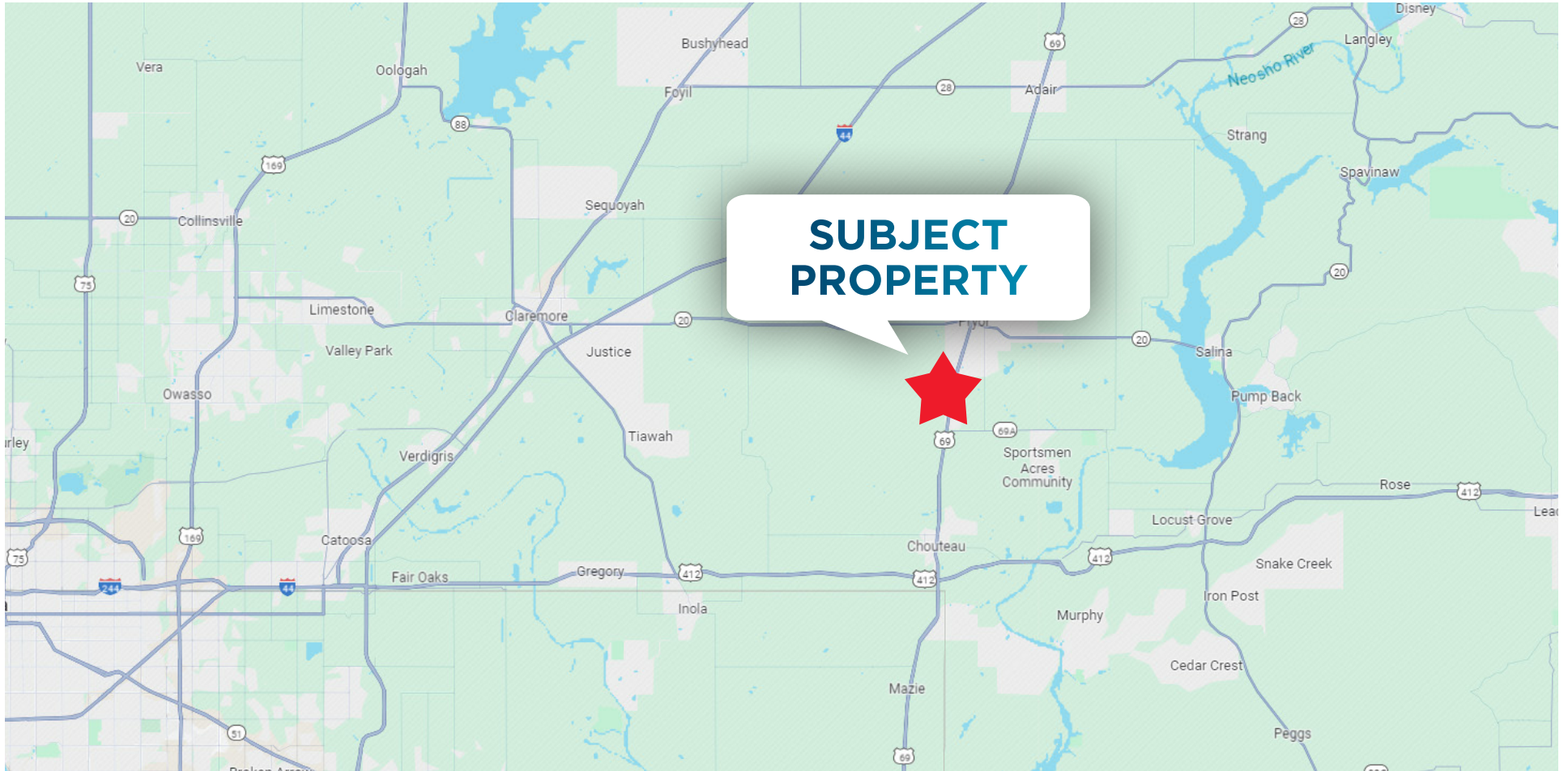

±23,000 CARS

PER DAY ON STATE HIGHWAY
69



±8 MILES

TO CLAREMORE REGIONAL
AIRPORT (KGCM)



±35 MILES

TO TULSA,
OKLAHOMA

Market Overview

The City Of Pryor Creek, OK

Pryor Creek, Oklahoma, is a vibrant city located in Mayes County, nestled in the northeastern part of the state. It's renowned for its rich history, diverse culture, and picturesque landscapes. Originally inhabited by Native American tribes, Pryor Creek was established as a settlement during the late 19th century, primarily due to the presence of abundant natural resources like coal and timber.



Today, Pryor Creek thrives as a bustling community with a strong economy driven by industries such as manufacturing, agriculture, and energy production. The city is home to several manufacturing plants and industrial parks, contributing significantly to its economic growth and providing employment opportunities for residents.

Pryor Creek boasts a range of amenities and attractions, including parks, recreational facilities, and cultural events. Residents and visitors alike can enjoy outdoor activities such as hiking, fishing, and camping in the nearby Ozark foothills and along the scenic Grand River.

The city also hosts various events throughout the year, celebrating its heritage and fostering community spirit. From annual festivals and rodeos to arts and crafts fairs, there's always something happening in Pryor Creek to entertain and engage people of all ages.

Overall, Pryor Creek, Oklahoma, is a dynamic city with a blend of history, industry, and natural beauty, making it an appealing destination for both residents and tourists.

Demographics



5,104

2022 AVERAGE
HOUSEHOLDS



\$75,053

2022 AVERAGE
HOUSEHOLD INCOME
(1 MILE RADIUS)



13,012

2022
POPULATION



Pensacola Dam



Pryor City Skyline

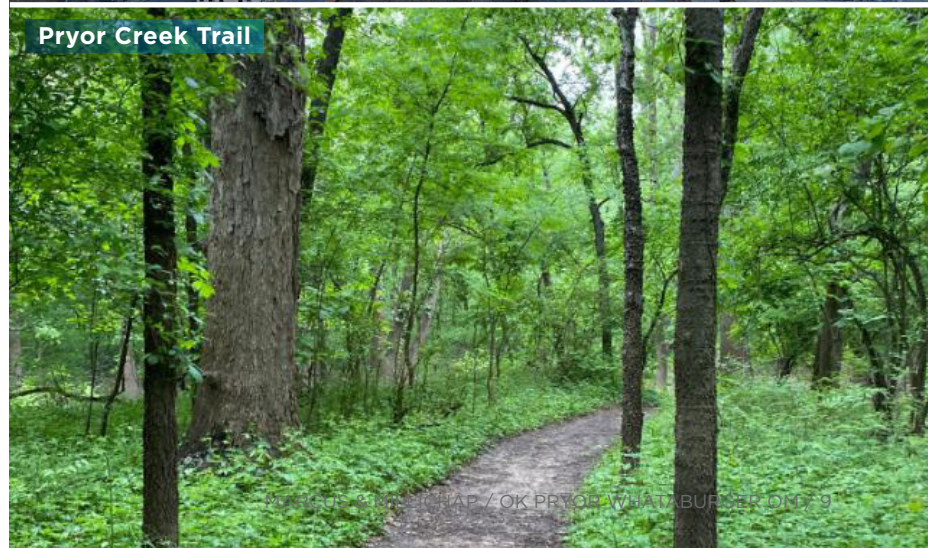

Pryor Creek Trail



WHATABURGER

BRAND NEW 20-YEAR LEASE AND 2024 CONSTRUCTION

PRYOR, OKLAHOMA

PRESENTED BY

CRAIG ELSTER

Vice President Investments
Director, Net Leased Properties Group
(949) 419-3223
craig.elster@marcusmillichap.com
Lic. CA 01958307

RON DUONG

Senior Managing Director Investments
Senior Director, National Retail Group
(949) 419-3233
ron.duong@marcusmillichap.com
Lic. CA 01438643

Broker of Record:

Steve Greer
7633 East 63rd Pl., Ste. 300
Tulsa, OK 74133
P: (225) 376-6800
License #: 206118

19800 MacArthur Boulevard, Suite 150, Irvine, CA 92612 / www.marcusmillichap.com

©2024 Marcus & Millichap. All rights reserved. The material in this presentation has been prepared solely for information purposes, and is strictly confidential. Any disclosure, use, copying or circulation of this presentation (or the information contained within it) is strictly prohibited, unless you have obtained Marcus & Millichap's prior written consent. The views expressed in this presentation are the views of the author and do not necessarily reflect the views of Marcus & Millichap. Neither this presentation nor any part of it shall form the basis of, or be relied upon in connection with any offer, or act as an inducement to enter into any contract or commitment whatsoever. NO REPRESENTATION OR WARRANTY IS GIVEN, EXPRESS OR IMPLIED, AS TO THE ACCURACY OF THE INFORMATION CONTAINED WITHIN THIS PRESENTATION, AND MARCUS & MILLICHAP IS UNDER NO OBLIGATION TO SUBSEQUENTLY CORRECT IT IN THE EVENT OF ERRORS.

Marcus & Millichap
DUONG INVESTMENT GROUP