



**NEW 20-YEAR LEASE
SINGLE TENANT NNN INVESTMENT**

KALAMAZOO MSA (PAW PAW), MI



ACTUAL PHOTO OF THE SUBJECT PROPERTY

Marcus & Millichap
DUONG INVESTMENT GROUP

OFFERING MEMORANDUM



NEW 20-YEAR LEASE SINGLE TENANT NNN INVESTMENT

KALAMAZOO MSA (PAW PAW), MI

Offering Memorandum Disclaimer

This Confidential Offering Memorandum ("Memorandum") is being delivered subject to the terms of the Confidentiality Agreement (the "Confidentiality Agreement") signed by you and constitutes part of the Confidential Information (as defined in the Confidentiality Agreement). It is being given to you for the sole purpose of evaluating the possible investment in the subject property mentioned herein ("the "Project"), and is not to be used for any other purpose or made available to any other party without the prior written consent of the Seller of Record ("Managing Member"), or its exclusive broker, Marcus & Millichap ("Exclusive Broker"). This Memorandum was prepared by Exclusive Broker based primarily on information supplied by Managing Member. It contains select information about the Project and the real estate market but does not contain all the information necessary to evaluate the Project. The financial projections contained herein (or in any other Confidential Information) are for general reference only. They are based on assumptions relating to the overall economy and local competition, among other factors. Accordingly, actual results may vary materially from such projections. Various documents have been summarized herein to facilitate your review; these summaries are not intended to be a comprehensive statement of the terms or a legal analysis of such documents. While the information contained in this Memorandum and any other Confidential Information is believed to be reliable, neither Exclusive Broker nor Managing Member guarantees its accuracy or completeness. Because of the foregoing and since the investment in the Project is being offered on an "As Is, Where Is" basis, a prospective investor or other party authorized by the prospective investor to use such material solely to facilitate the prospective purchaser's investigation, must make its independent investigations, projections and conclusions regarding the investment in the Project without reliance on this Memorandum or any other Confidential Information. Although additional Confidential Information, which may include engineering, environmental or other reports, may be provided to qualified parties as the marketing period proceeds, prospective purchasers should seek advice from their own attorneys, accountants, engineers and environmental experts. Neither Exclusive Broker nor Managing Member guarantees the accuracy or completeness of the information contained in this Memorandum or any other Confidential Information provided by Exclusive Broker and Managing Member. Managing Member expressly reserves the right, at its sole discretion, to reject any offer to invest in the Project or to terminate any negotiations with any party at any time with or without written notice. Managing Member shall have no legal commitment or obligations to any prospective investor unless and until a written sale agreement has been fully executed, delivered and approved by Managing Member and any conditions to Managing Member's obligations thereunder have been satisfied or waived. Managing Member has retained Exclusive Broker as its exclusive broker and will be responsible for any commission due to Exclusive Broker in connection with a transaction relating to the Project pursuant to a separate agreement. Exclusive Broker is not authorized to make any representation or agreement on behalf of Managing Member. Each prospective investor will be responsible for any claims for commissions by any other broker in connection with an investment in the Project if such claims arise from acts of such prospective investor or its broker. This Memorandum is the property of Managing Member and all parties approved by Managing Member and may be used only by parties approved by Managing Member. No portion of this Memorandum may be copied or otherwise reproduced or disclosed to anyone except as permitted under the Confidentiality Agreement.

EXCLUSIVELY LISTED BY:

CRAIG ELSTER

Vice Presidents Investments

(949) 419-3223

craig.elster@marcusmillichap.com

Lic. CA 01958307

RON DUONG

Senior Managing Director Investments

Senior Director, National Retail Group

(949) 419-3233 direct

ron.duong@marcusmillichap.com

License: CA 01438643

BROKER OF RECORD:

Paul Kerber

License: 6502433613

Two Towne Square, Suite 450

Southfield, MI 48076

Phone: (248) 415-2600

INVESTMENT HIGHLIGHTS



Successful Store with a 7.5% Rent-to-Sales Ratio



New, 20-Year Wendy's Sale-Leaseback



Freeway-Close Location – Less Than ½ Mile From Interstate-94, Connecting Detroit to Chicago with a Traffic Counts Exceeding 46,000 Cars Per Day

Prime Retail Location

- ▶ **Highly-Trafficked Location Located on the Corner of a Signalized Intersection (Combined Traffic Counts Exceed 20,000 Cars Per Day)**
- ▶ Located on Main Retail Corridor in Close Proximity to Several Major Retailers such as Walmart, Tractor Supply Co, Speedway, Jimmy John's, Family Fare Supermarket, CITGO, Walgreens, Taco Bell, AutoZone, Advance Auto Parts, and Many More
- ▶ **Affluent Area with the Average Household Income Exceeding \$92,000 within 5 Miles**

Experienced Franchisee

- ▶ **Absolute NNN Property with Zero Landlord Responsibilities** – Ideal for Investors Not Local to the Market
- ▶ **Meritage Hospitality Group is One of the Largest Wendy's Franchisee's in the Country with Over 12,000 Employees and 380 Locations in 16 States**
- ▶ Scheduled 1.5% Annual Rental Increases Throughout the Initial Term Provide for an Excellent Hedge Against Inflation



TENANT OVERVIEW

Wendy's®

Wendy's® is a globally recognized fast-food restaurant chain known for its square hamburgers, fresh ingredients, and innovative menu offerings. Founded by Dave Thomas in 1969 in Columbus, Ohio, Wendy's quickly grew from a single location to become one of the largest and most beloved fast-food chains in the world.



Today, Wendy's operates thousands of restaurants worldwide, offering a diverse menu that caters to a wide range of tastes and preferences. With a focus on innovation, quality, and customer satisfaction, Wendy's continues to be a leader in the fast-food industry, providing delicious meals and memorable dining experiences for millions of people every day.

Website:	www.wendys.com
# of Locations:	7,000+ (6,500+ U.S. Locations)
Ticker:	NASDAQ: WEN
Revenue:	\$2.246 Billion (2024)



Meritage Hospitality Group

Frosty, Burgers, and Fries—what is not to love? On November 15, 1969, Dave Thomas opened his very first Wendy's® restaurant in Columbus, Ohio.



In no time, the quick-service chain became known for its square beef patties, made from fresh beef, and iconic Frosty® desserts. There are now more than 6,500 Wendy's® restaurants currently in operation in the United States and 29 countries and U.S. territories worldwide.

Meritage is proud to have recently opened one of the first Global Next Gen Wendy's restaurants in Edmond, OK. [Click here to learn more.](#)

The Company is the nation's only publicly traded Wendy's restaurant franchisee and their public filings can be viewed at www.otcmkts.com, under the stock symbol MHGU, or the Company's website.

Website:	www.meritagehospitality.com
Headquarters:	Grand Rapids, MI
Employees:	12,000+
Ticker:	OTCMKTS: MHGU
Revenue:	\$668.80 Million (2024)

MARKET OVERVIEW

Aerial Photo



To Kalamazoo, MI
±20 Miles via I-94

Walmart
Save money. Live better.

TSC TRACTOR SUPPLY CO.

INTERSTATE
94

Shopping Center
Redevelopment
(Under Construction)

SunBerry
FARMS
Distribution Center

McDonald's

FAMILY
FARE
SUPERMARKETS

TACO
BELL

Pizza
Hut

Speedway

Walgreens

Burger King

Jimmy John's

Red's Root Beer

Arby's

S. Kalamazoo Street
±20,000 Cars Per Day

Ford

ST JULIAN
WINERY & DISTILLERY

Michigan's Most-Awarded Winery
Operating in MI for Over 100 Years



Wendy's



FINANCIAL ANALYSIS

Offering Summary

Property Name	Wendy's
Property Address	828 S. Kalamazoo Street Paw Paw, MI 49079
Assessor's Parcel Number	80-47-583-048-00
Year Built	2016
Gross Leasable Area (GLA)	±2,869 Square Feet
Lot Size	±1.16 Acres (±50,530 Square Feet)

Pricing

Price	\$2,047,000
Cap Rate	6.30%

Annualized Operating Data

Gross Potential Rent	\$129,000
Total Expenses	Absolute NNN
Net Operating Income	\$129,000

Lease Information

Initial Lease Term	±20 Years
Lease Commencement Date	Close of Escrow
Lease Expiration Date	±20 Years From Close of Escrow
Increases	Annual CPI (1.50% Maximum)
Options	Six, Five-Year
Guarantee	Franchisee (380+ Units)
Lease Type	Absolute NNN
Lease Type Details	Zero Landlord Responsibilities



PROPERTY PHOTOS



MARKET OVERVIEW

Regional Map

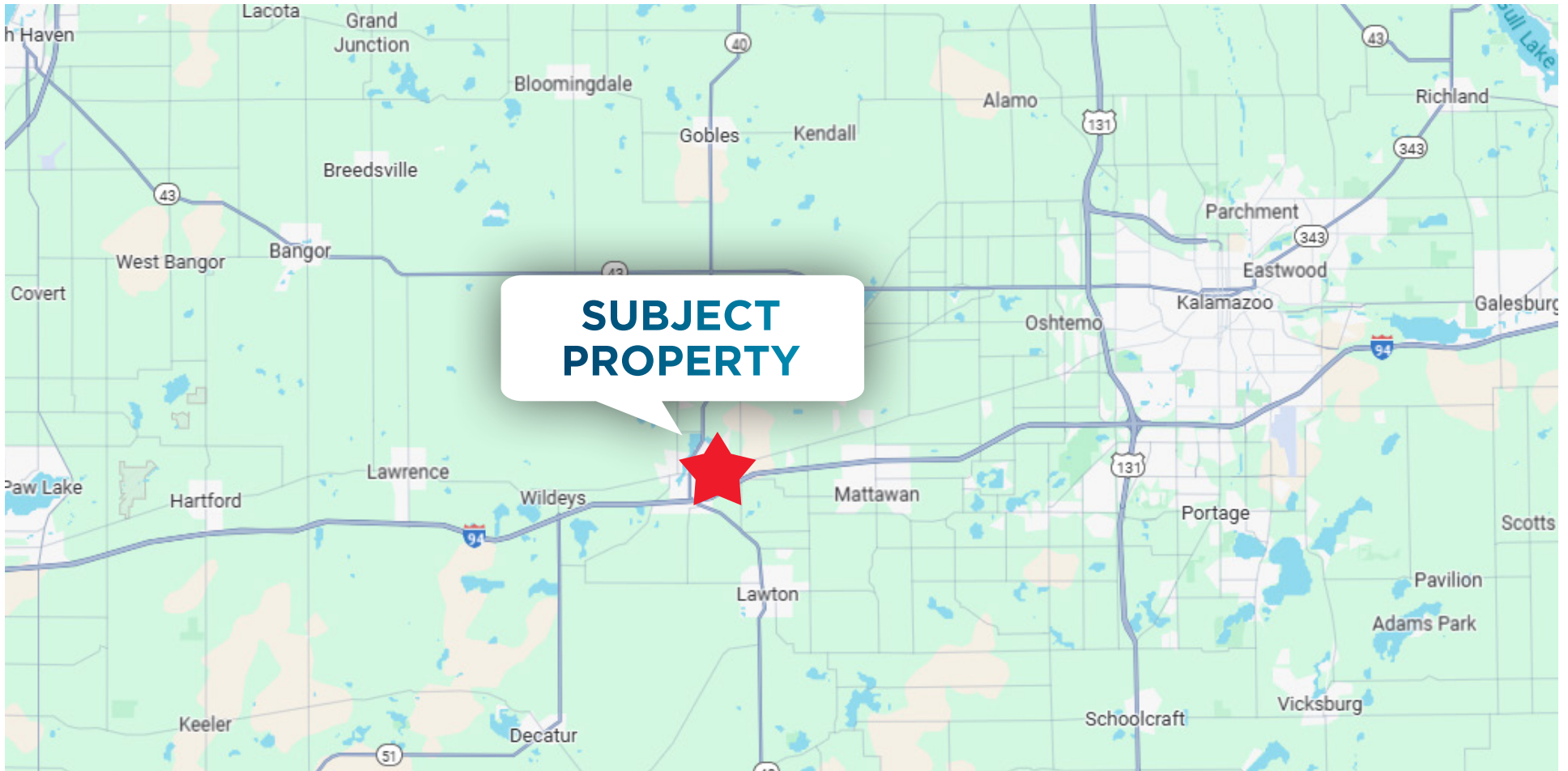

±40,000

CARS PER DAY ON
NEARBY INTERSTATE 94



±18 MILES

TO KALAMAZOO/BATTLE CREEK
INTERNATIONAL AIRPORT (AZO)



±20 MILES

TO DOWNTOWN
KALAMAZOO, MI



±20,000

ON KALAMAZOO STREET
(M-40 HIGHWAY)

MARKET OVERVIEW

The Village of Paw Paw, MI

Paw Paw benefits from its placement within the Kalamazoo Metropolitan Statistical Area, one of southwest Michigan's most balanced regional economies. The market is anchored by higher education, life sciences, manufacturing, and logistics, producing stable employment and consistent population growth over the past decade. Retail fundamentals remain supported by the area's mix of local and regional consumers, with Kalamazoo serving as a retail and service hub for surrounding Van Buren and Allegan counties.



Interstate 94 serves as the area's primary commercial corridor, linking Paw Paw directly to Kalamazoo and Benton Harbor as well as major regional markets such as Chicago and Detroit. This corridor supports steady traveler traffic, commuter flow, and distribution activity, which in turn drives strong quick-service restaurant and convenience retail performance. Retail along I-94 has benefited from both consumer mobility and limited new supply, sustaining demand for modern, single-tenant assets.

The Kalamazoo MSA continues to record healthy retail occupancy and moderate rent growth, supported by resilient local spending and institutional stability from major employers including Stryker, Pfizer, and Western Michigan University. The Paw Paw submarket captures a balanced consumer base of residents and travelers, providing a consistent revenue environment for national operators. With strong franchisee presence and limited competition for prime frontage, the area remains a reliable market for long-term net lease investment.

Income & Economics

	1-Mile	3-Mile	5-Mile
Average Household Income	\$76,561	\$88,994	\$92,636
Average Home Value	\$147,762	\$191,023	\$207,698
2024 Daytime Population	3,738	9,666	19,880

Population

	1-Mile	3-Mile	5-Mile
2029 Population	2,788	9,014	19,112
2024 Population	2,802	8,987	18,986
2010 Population	2,854	8,539	17,936

Households

	1-Mile	3-Mile	5-Mile
2029 Households	1,213	3,661	7,606
2024 Households	1,202	3,617	7,505
2010 Households	1,147	3,375	6,945





NEW 20-YEAR LEASE SINGLE TENANT NNN INVESTMENT

KALAMAZOO MSA (PAW PAW), MI

EXCLUSIVELY LISTED BY

CRAIG ELSTER

Vice President Investments
Director, Net Leased Properties Group
(949) 419-3223
craig.elster@marcusmillichap.com
Lic. CA 01958307

RON DUONG

Senior Managing Director Investments
Senior Director, National Retail Group
(949) 419-3233
ron.duong@marcusmillichap.com
Lic. CA 01438643

Broker of Record:

Paul Kerber
License: 6502433613
Two Towne Square, Suite 450
Southfield, MI 48076
Phone: (248) 415-2600

19800 MacArthur Boulevard, Suite 150, Irvine, CA 92612 / www.marcusmillichap.com

©2024 Marcus & Millichap. All rights reserved. The material in this presentation has been prepared solely for information purposes, and is strictly confidential. Any disclosure, use, copying or circulation of this presentation (or the information contained within it) is strictly prohibited, unless you have obtained Marcus & Millichap's prior written consent. The views expressed in this presentation are the views of the author and do not necessarily reflect the views of Marcus & Millichap. Neither this presentation nor any part of it shall form the basis of, or be relied upon in connection with any offer, or act as an inducement to enter into any contract or commitment whatsoever. NO REPRESENTATION OR WARRANTY IS GIVEN, EXPRESS OR IMPLIED, AS TO THE ACCURACY OF THE INFORMATION CONTAINED WITHIN THIS PRESENTATION, AND MARCUS & MILLICHAP IS UNDER NO OBLIGATION TO SUBSEQUENTLY CORRECT IT IN THE EVENT OF ERRORS.